

## 20.Key Lock Cylinders

### A: REPLACEMENT

#### 1. STEERING LOCK

1) Disconnect the ground cable from battery. <Ref. to NT-5, BATTERY, NOTE, Note.>

##### NOTE:

For the 12 volt engine restart battery of HEV model, disconnect the ground terminal from 12V engine restart battery sensor.

2) Remove the cover assembly - column.

(1) Remove the screws by turning the steering wheel to right and left.

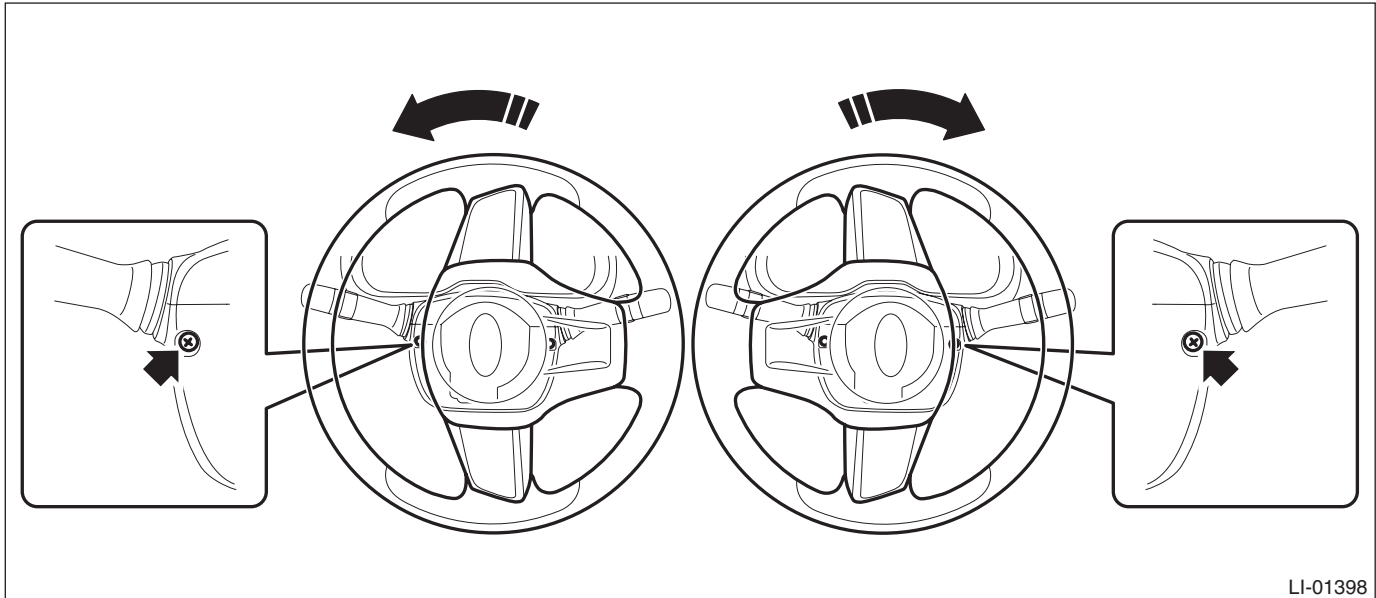

(2) Release the claw, and remove the cover assembly - column UPR and the cover assembly - column LWR.

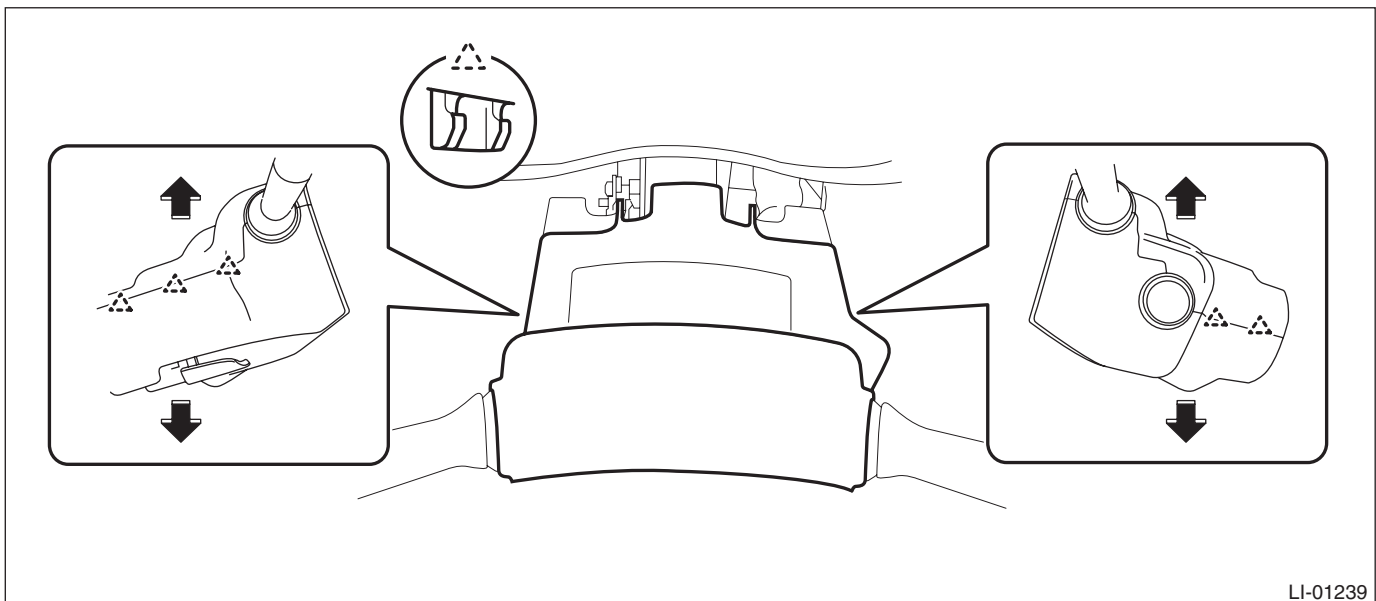

# Key Lock Cylinders

## SECURITY AND LOCKS

- 3) Remove the immobilizer antenna assembly or the ignition switch illumination.
  - (1) Disconnect the connector.
  - (2) Release two claws using a flat tip screwdriver or similar tool wrapped with a protection tape, and remove the immobilizer antenna assembly or the ignition switch illumination.

### CAUTION:

**Do not apply excessive force to disengage the lock of immobilizer antenna assembly or ignition switch illumination. Otherwise they may be broken because those parts are the products made of a plastic.**

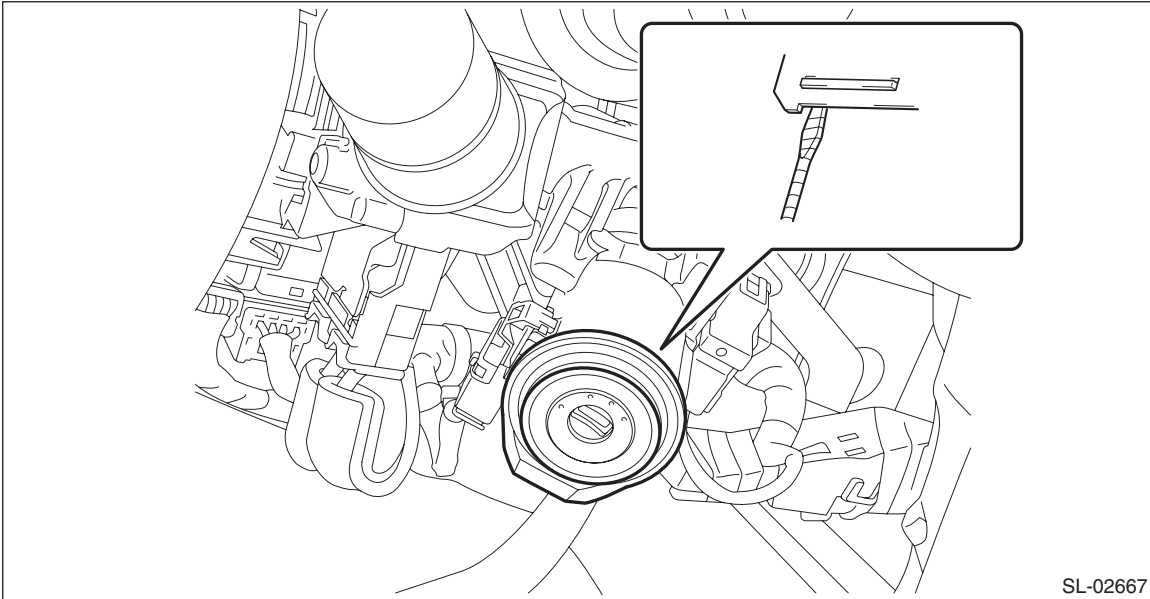

- 4) Remove the key lock solenoid.
  - (1) Disconnect the connector.
  - (2) Remove the screws and remove the key lock solenoid.

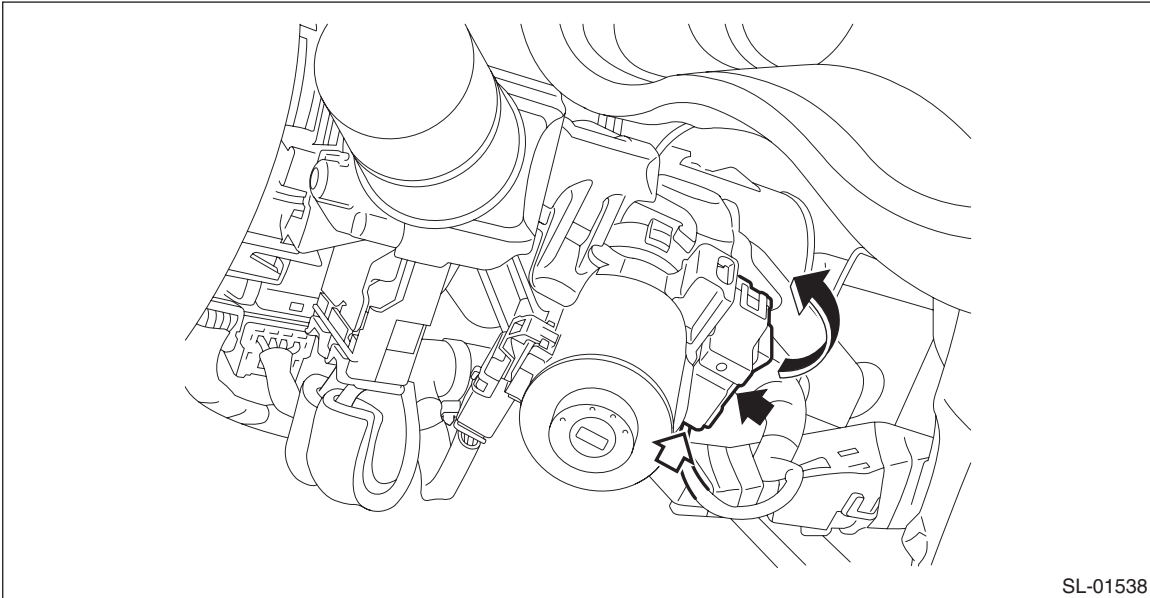

5) Replace the key cylinder.

(1) Insert the key into the key cylinder, and turn the key to the ACC position.

(2) Insert a flat tip screwdriver from the steering lock frame hole (A), and pull the key cylinder until the key cylinder claws touch the steering lock frame stopper (B).

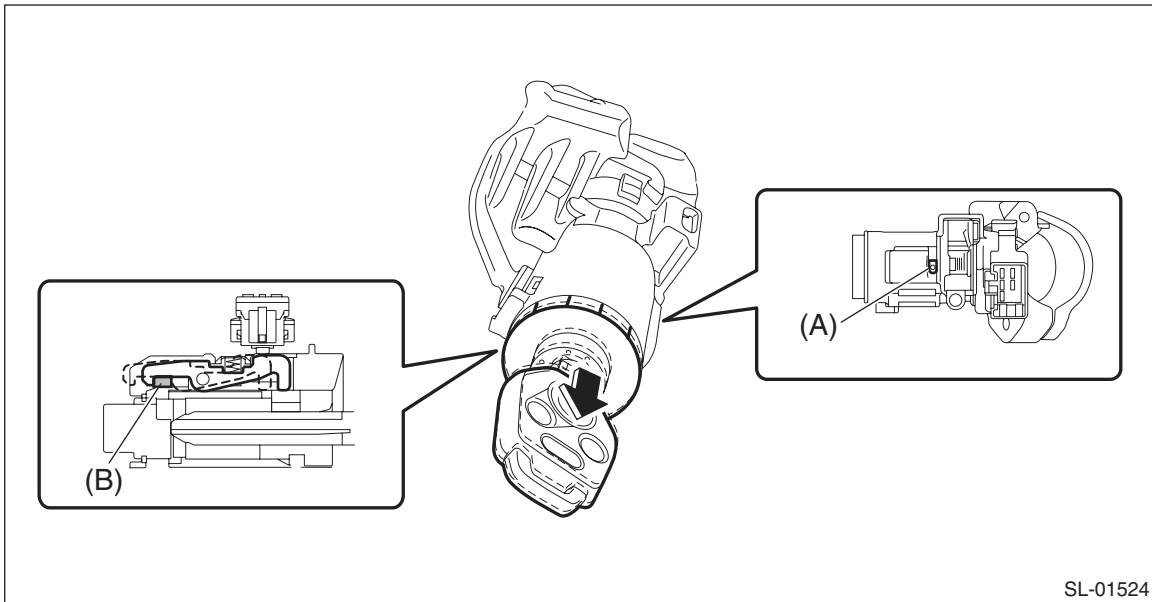

(3) Insert a flat tip screwdriver from the steering lock frame hole (A), and release the claws to pull out the key cylinder.

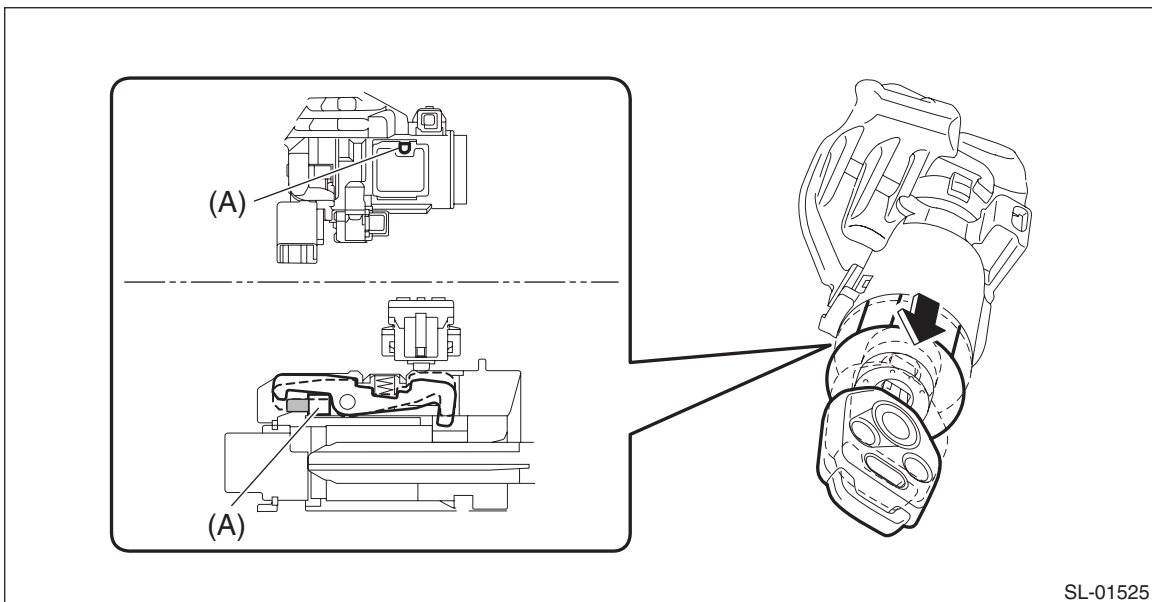

6) Install each part in the reverse order of removal.

# Key Lock Cylinders

## SECURITY AND LOCKS

### 2. FRONT DOOR

- 1) Raise the glass assembly - front door to the top position.
- 2) Remove the cover - handle front outer.

#### **Preparation tool:**

##### **TORX® T30**

- (1) Remove the plug at the rear end of the panel assembly - front door.
- (2) Loosen the TORX® bolt and remove the cover - handle front outer.

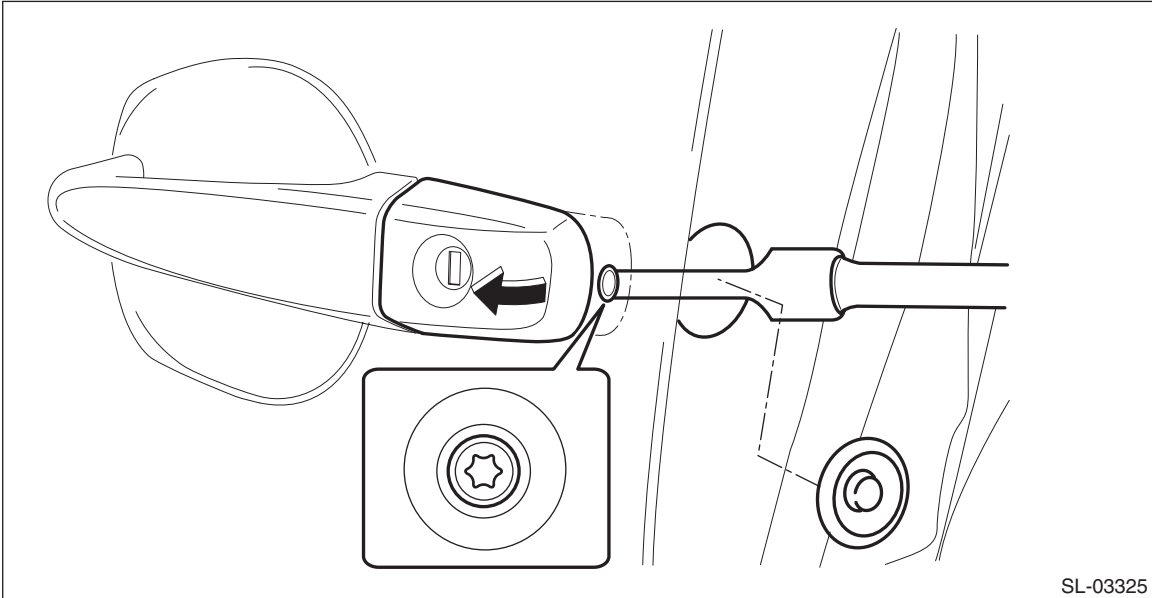

- 3) Remove the key cylinder (B) from the cover - handle front outer (A), and replace the key cylinder.

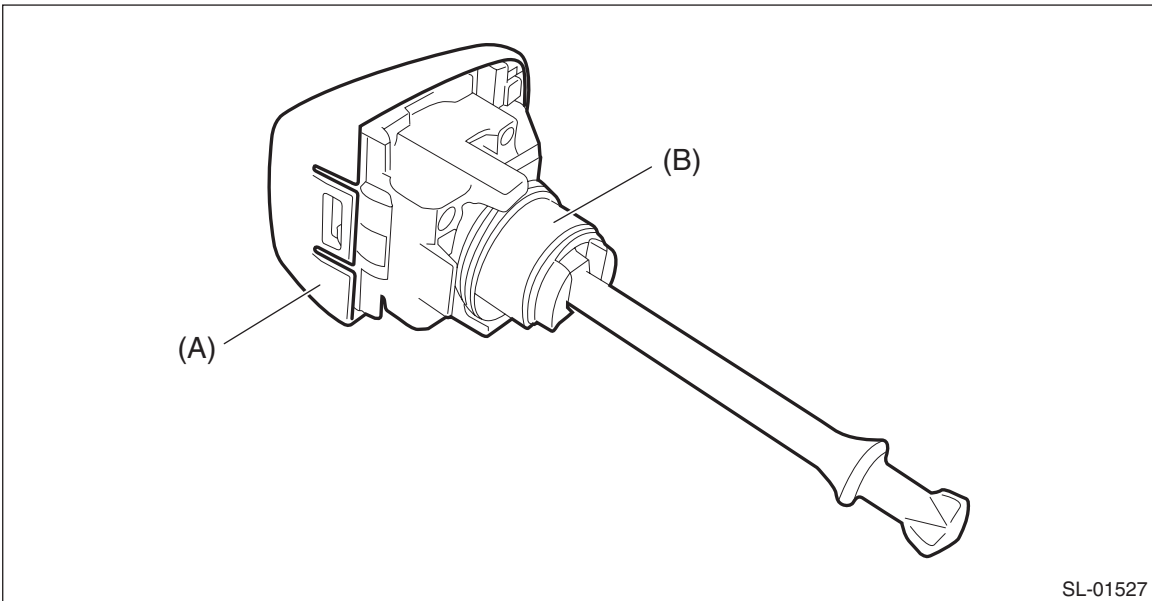

- 4) Install each part in the reverse order of removal.

#### **CAUTION:**

When installing the cover - handle front outer on driver's side, make sure that the key cylinder shaft is correctly inserted into the latch & actuator assembly - front.

#### **Tightening torque:**

Refer to "COMPONENT" of "General Description". <Ref. to SL-2, DOOR LOCK ASSEMBLY, COMPONENT, General Description.>

## 3. GLOVE BOX LID

### 1) Remove the pocket assembly.

- (1) Attach the protective tape (a) to the panel center LWR.
- (2) Remove the damper COMPL - pocket.
- (3) Release the stoppers and remove the pocket assembly by pulling it toward you.

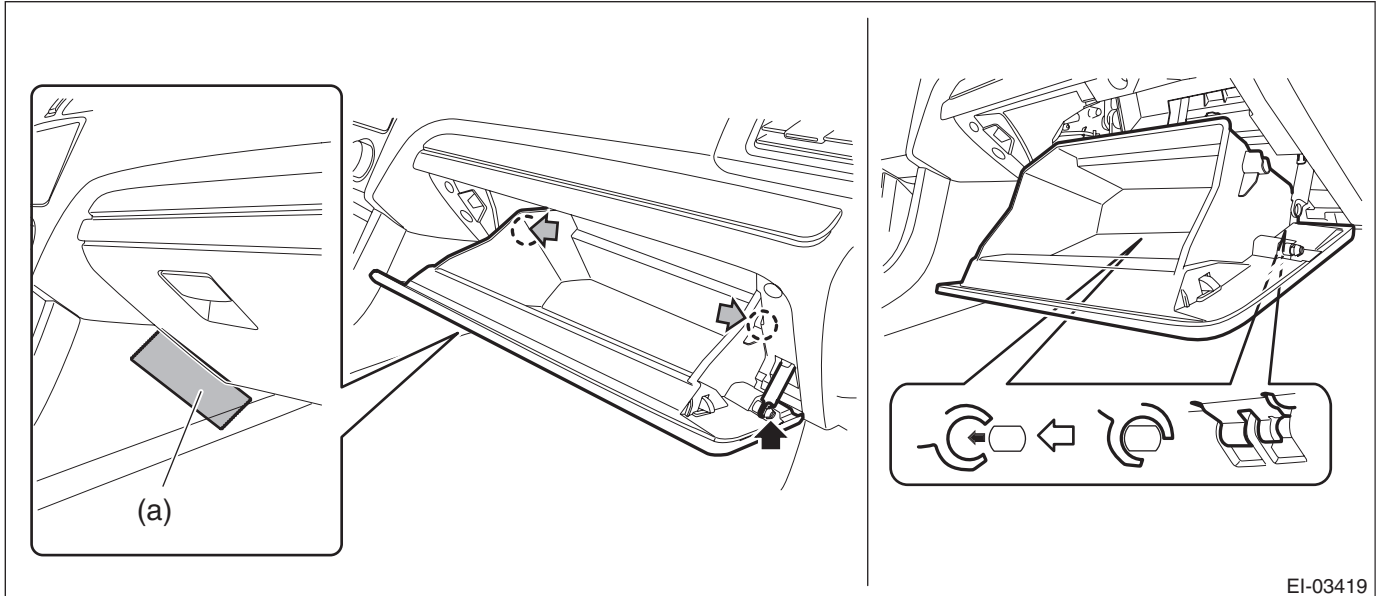

### 2) Replace the key cylinder.

- (1) Pull up the lock knob.
- (2) Push out the key cylinder from the pocket assembly while pressing in the metal plate.

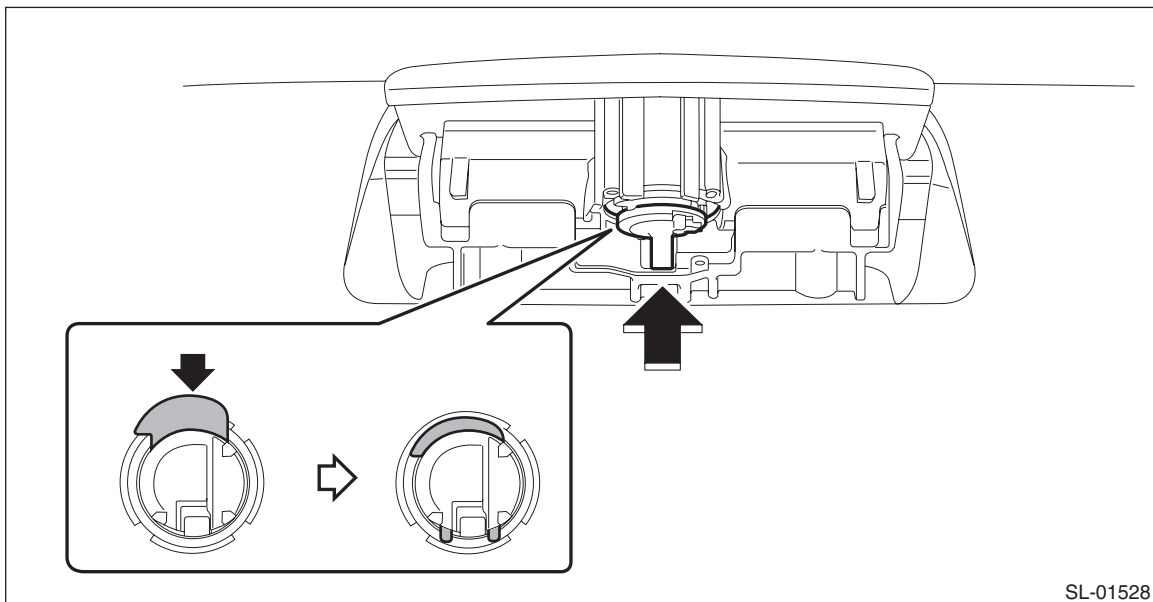

### 3) Install each part in the reverse order of removal.